

PULSE VALVE

SCG SERIES

PRODUCT OVERVIEW

1. SCG Series pulse valves are designed specifically for dust applications with high flow, long life and fast on / off switching characteristics, to ensure economic and reliable work.
2. Angle valve body. Special stainless steel piston / diaphragm, and new flow theory supply unique characteristics for operation
3. High-quality TPE piston / diaphragm, long service life, wide working temperature range
4. Stainless steel clamps, bolts rust and jamming will not happen, maintenance quickly and easily.



ORDERING CODE

SCG 353 A J 043 - AC220V

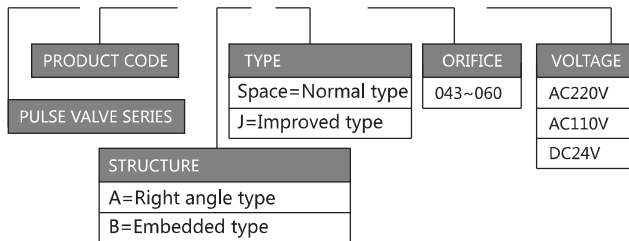

SPECIFICATION						
Type	Port Size	Orifice	Kv / Cv		Pressure	
			M ³ /h	l/min	Mix	Max
SCG353A043	3/4"	25	14	233	0.3	8.5
SCG353AJ043	3/4"	25	14	233	0.3	8.5
SCG353A044	1"	25	23	283	0.3	8.5
SCG353AJ044	1"	25	23	283	0.3	8.5
SCG353A047	1 1/2"	52	46	768	0.35	8.5
SCG353A050	2"	66	77	1290	0.35	8.5
SCG353A051	2 1/2"	66	92	1540	0.35	8.5
SCG353B060	3"	75	170	2833	1	6

INSIDE STRUCTURE

NO	Name	Material instruction
①	Coil	Good quality wire
②	Pilot kits	430FR stainless steel
③	Small cap	ADC aluminium
④	Diaphragm kits	Imported NBR
⑤	Up cap	ADC aluminium
⑥	Big spring	321 stainless steel
⑦	Fastener	302 stainless steel
⑧	Diaphragm kits	Imported NBR
⑨	Valve body	ADC aluminium

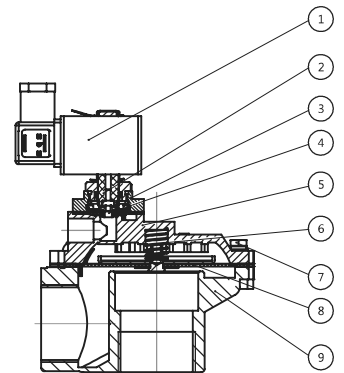

INDEX							
Working Pressure	Working Medium	Voltage	Current	Temperature Level	Relative Humidity of Air	Protection Class	Diaphragm life
0.4~0.6(MPa)	Clean air	DC24V	0.8A	1 -25°C~80°C -13°F ~176°F	≤85%	IP65	One million blows or 3years
		AC110V	0.46A	2 -25°C~150°C -13°F ~302°F			
		AC220V	0.23A	3 -25°C~230°C -13°F ~446°F			

PULSE VALVE

SCG SERIES

DIMENSION

